



www.Zricks.com



ZRICKS.COM

www.Zricks.com







ZRICKS

www.Zricks.com







www.Zricks.com



www.Zricks.com



ZRICKS



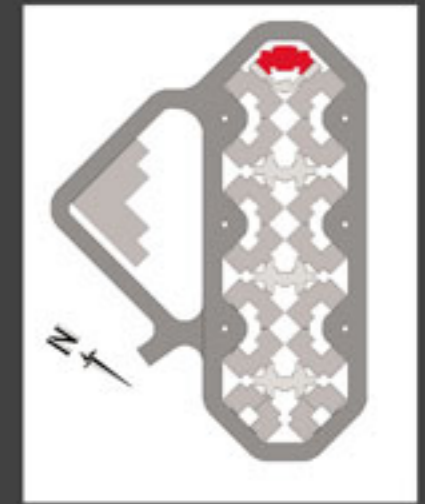

Type : 2 BHK

Saleable Area : 1359 SFT

A - Foyer : 5'9" X 5'2"

B - Living : 15'7 X 10'8"

C - Balcony : 11'9" X 4'9"

D - Bedroom : 10'8" X 11'8"

E - Toilet : 8'2" X 5'2"

F - Toilet : 8'8" X 5'2"

G - Balcony : 11'2" X 3'6"

H - M. Bedroom : 11'5" X 13'7"

I - Kitchen : 11'4" X 9'8"

J - Utility : 11'1" X 5'2"

K - Dining : 11'8" X 9'8"



Type : 2 BHK

Saleable Area : 1386 SFT

A - Foyer : 5'11" x 5'3"	D - Toilet : 7'10" x 4'11"	G - M. Bedroom : 10'10" x 13'6"	J - Kitchen : 9'10" x 11'12"
B - Living : 11'8" x 15'9"	E - Bedroom : 11'10" x 10' 10"	H - Toilet : 8'2" x 5'3"	K- Dining : 9'10" x 15'9"
C - Balcony : 9'10" x 4'11"	F - Balcony : 27.98	I - Utility : 5'3" x 11'2"	



Type : 3 BHK

Saleable Area : 1778 SFT

A - Foyer : 5'11" x 5'3"

B - Living : 12'0" x 15' 9"

C - Dining : 11'12" x 16'1"

D - Kitchen : 11'6" x 9'2"

E - Utility : 5'2" x 9'2"

F - Toilet : 4'11" x 8'2"

G - Bedroom : 10'10" x 11'10"

H - M. Bedroom : 11'2" x 10'10"

I - Balcony : 10'10" x 3'7"

J - Toilet : 5'3" x 8'10"

K - Toilet : 8'2" x 4'11"

L - Bedroom : 11'2" x 11'10"

M - Balcony : 10'10" x 3'7"

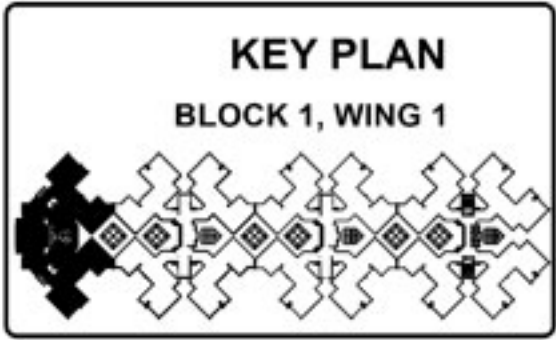
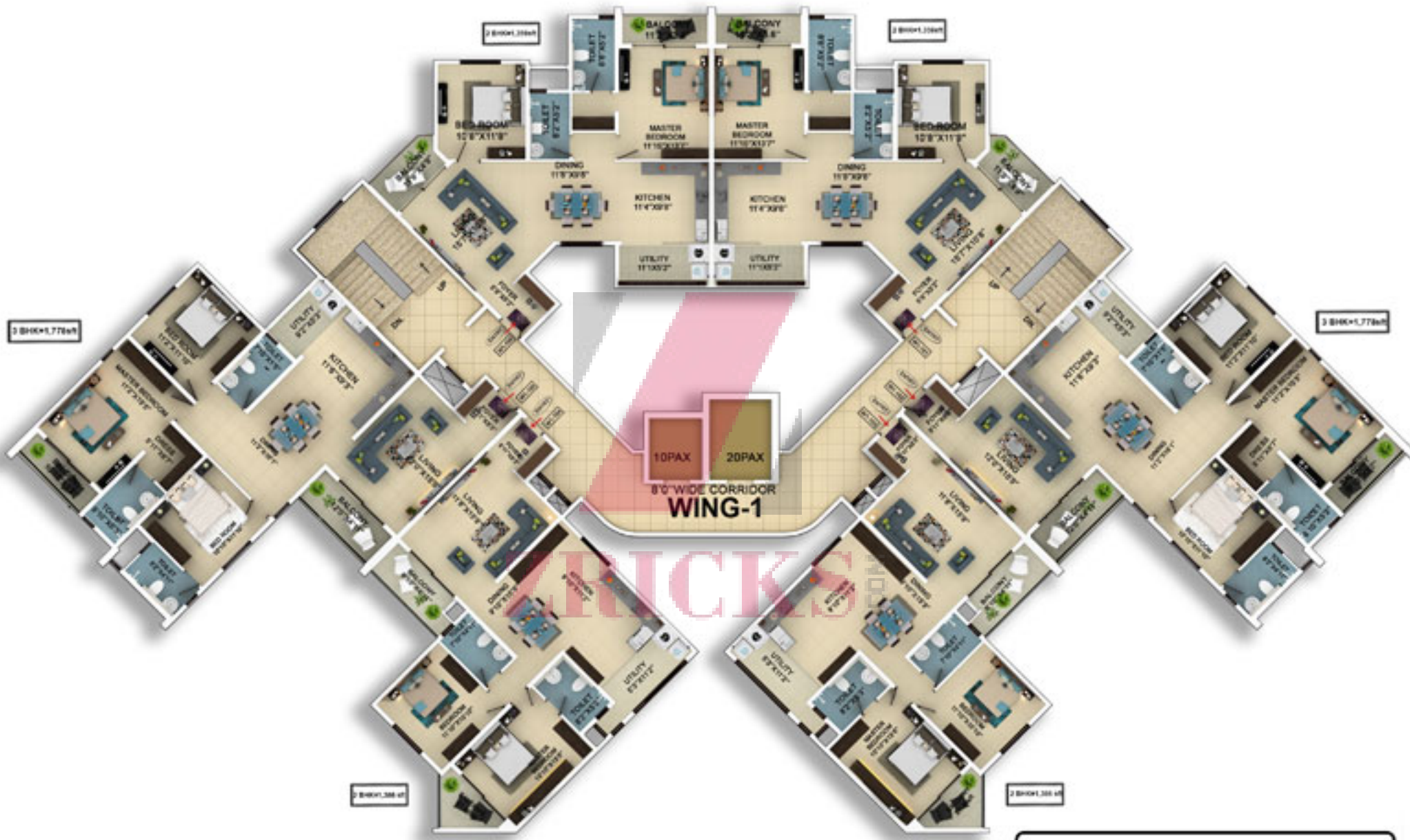

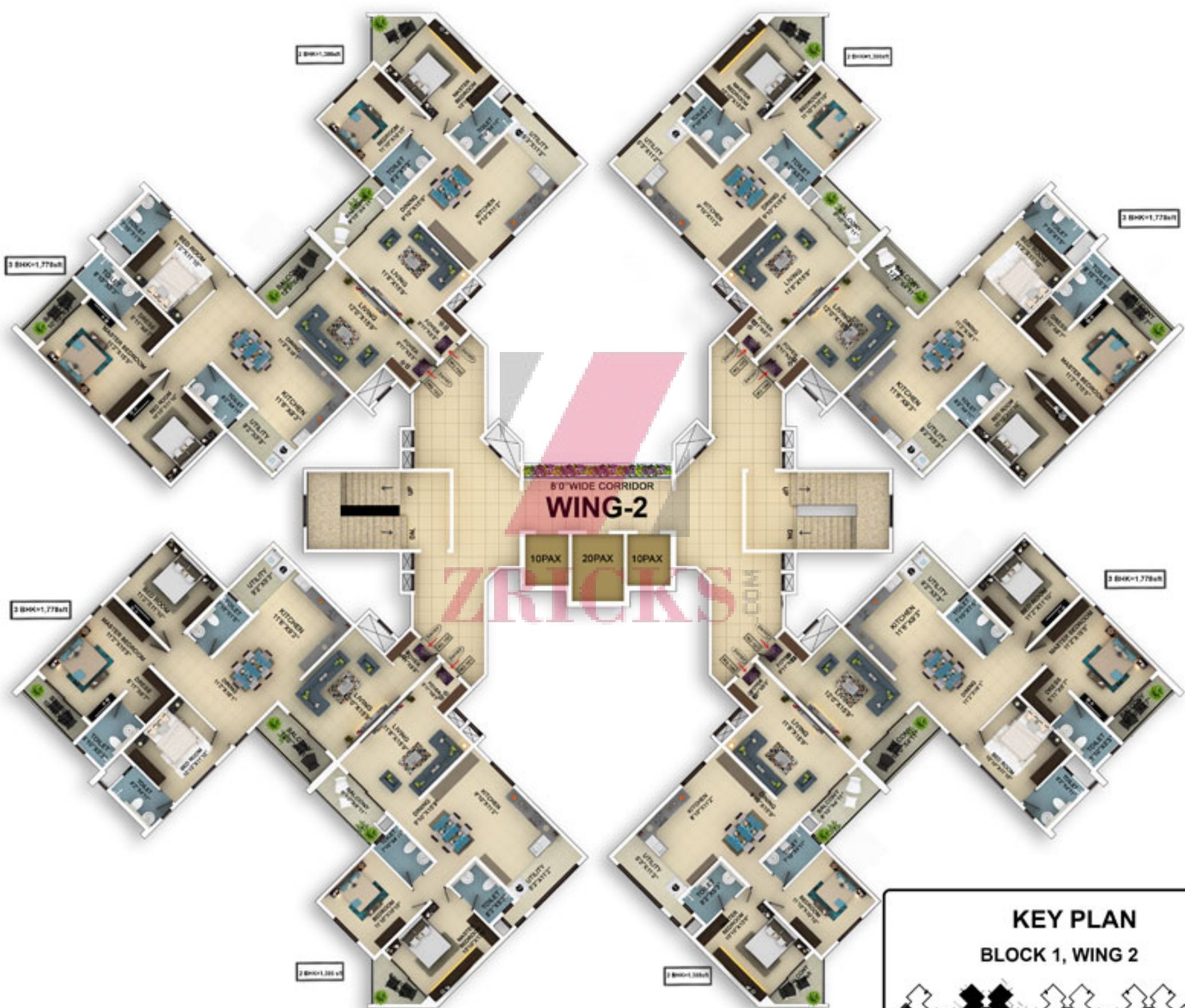

8'0" WIDE CORRIDOR
WING-2

10PAX 20PAX 10PAX

ZRICKS.COM

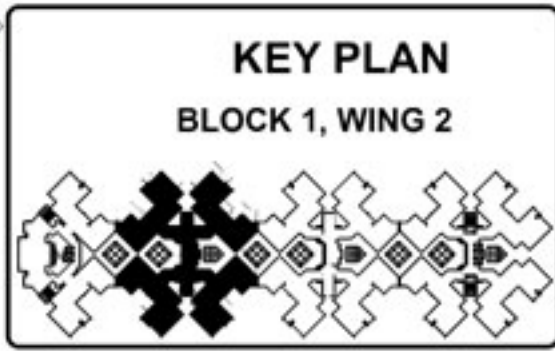

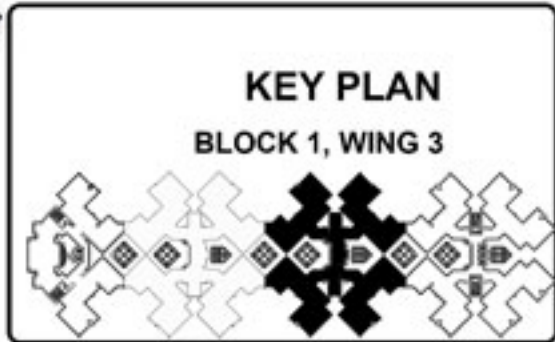
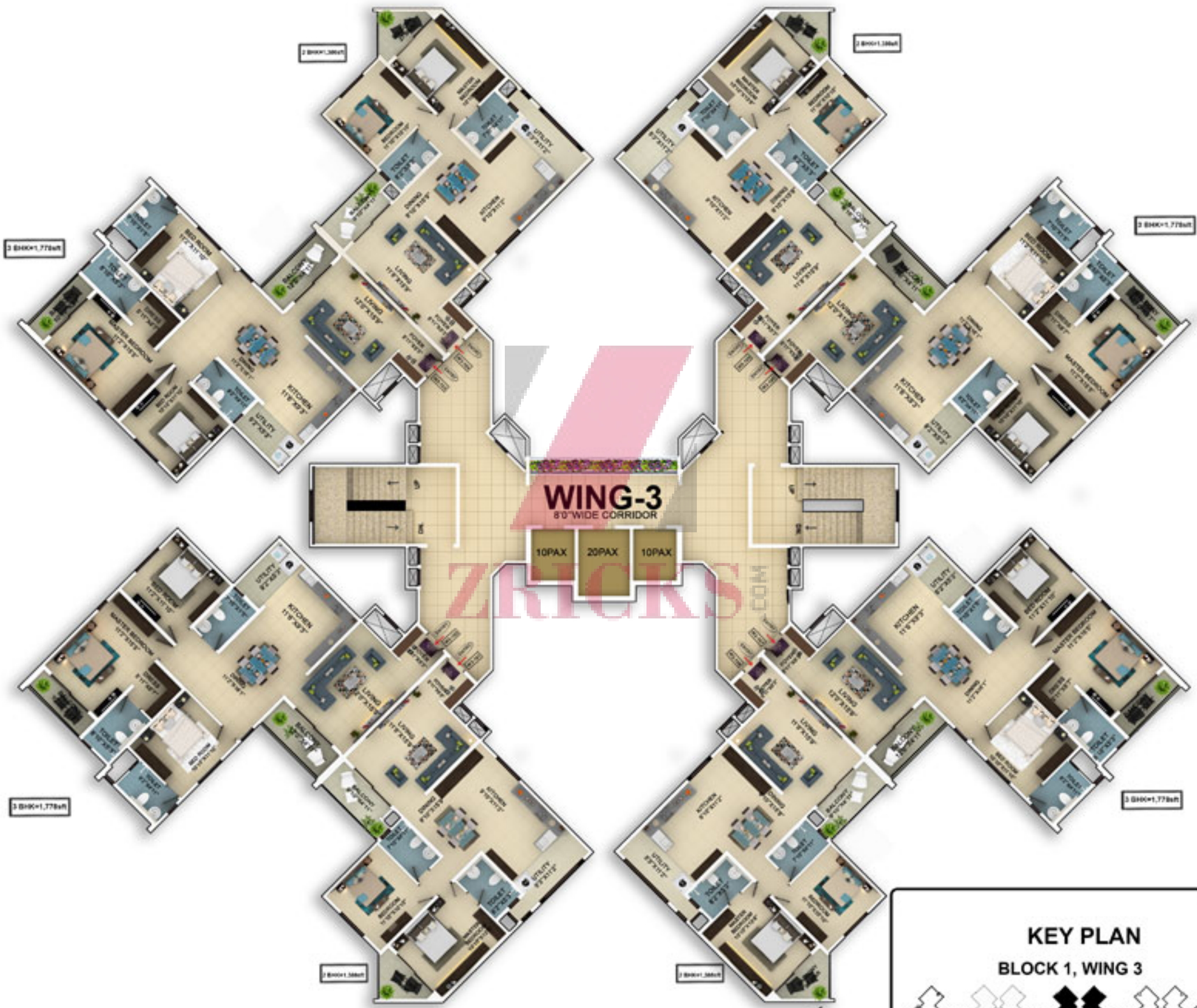

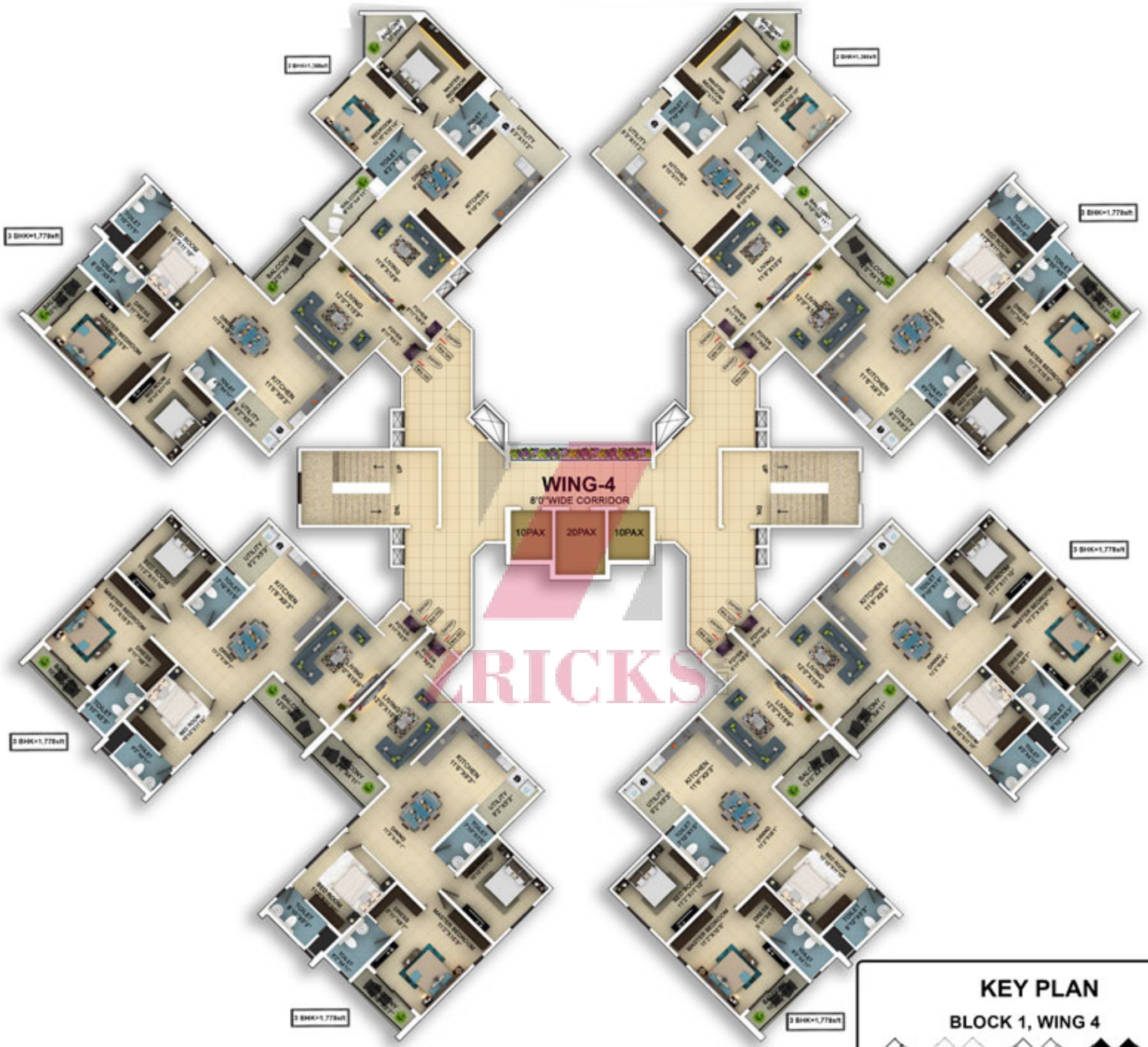

WING-4

8'0" WIDE CORRIDOR

10PAX 20PAX 10PAX

ZRICKS

